

CONSTRUCTION Extruded aluminum housing with die cast aluminum gasketed end caps.

REFLECTOR Highly reflective die-formed specular anodized aluminum with asymmetric computer-generated distribution.

LENS Standard indoor fluorescent luminaires are "open" without lensing unless otherwise specified. For Outdoor fluorescent luminaires, gasketed UV stabilized acrylic lens is secured over fixture opening.

ELECTRICAL Standard T5 and T5HO: Program start 120/277 volt integral electronic ballast with less than 10% THD. Standard Biax: Program start 120/277 volt integral electronic ballast with less than 15% THD. Standard T8: Instant start 120/277 volt electronic ballast with less than 10% THD. Through wiring with quick connects standard. Standard single circuit. Each ballast provided with disconnects to meet luminaire disconnect code requirement.

MOUNTING Heavy gauge aluminum brackets mount to structure allowing for easy installation and adjustment of fixture head. Bracket are painted to match fixture housing unless otherwise specified.

FINISH Standard powder-coat white painted finish. Consult factory for custom color and finishes.

LABELS UL and cUL Listed and approved for dry/damp location or wet location. Specify label required under "Product" section of catalog number.

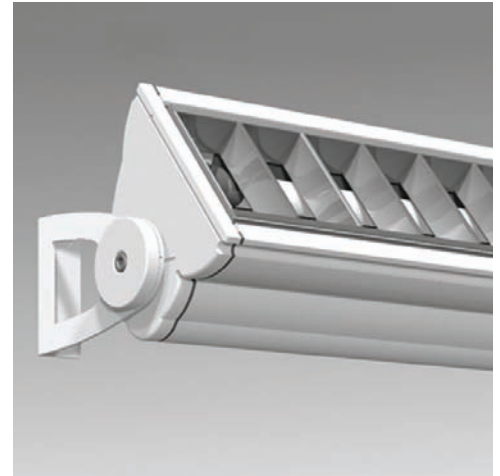
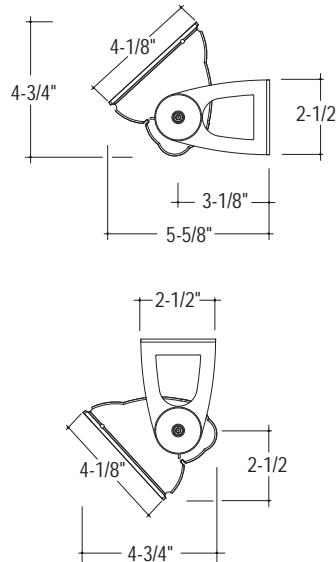

Shown with optional louver (L). Peak Linear is standard "open" without louver, visor or lens.

LUMINAIRE SPECIFICATION

Sample Catalog #: P-1T5-4'-FL-120-1C-W

PRODUCT	LAMPS	LENGTH	MOUNTING	VOLTAGE	CIRCUITING	FINISH	OPTIONS
P- Peak Linear indoor luminaire, cUL dry/damp label	1T5- (1) T5 Lamp 1T5HO- (1) T5HO Lamp 2T5- (2) T5 Lamps 2T5HO- (2) T5HO Lamps	Individual Units 3- 3' Biax not available 4- 4' 6- 6' Biax not available 8- 8'	FL- Flush Mount	120- 120 V 277- 277 V 347- 347 V ² UNV- UNV ² (120/277)	1C- Single Circuit 2C- Dual Circuit ³ 1D- Single Circuit Dimming ³ 2D- Dual Circuit Dimming ³ 1B- Single Circuit with Battery Pack ³ 2B- Dual Circuit with Battery Pack ³ 1E- Single Circuit with Emergency Circuit ³ 2E- Dual Circuit with Emergency Circuit ³	W- Matte White S- Metallic Silver BR- Bronze CC- Custom Color	LC- Lens Cover V- Visor L- Louver ⁴
PW- Peak Linear outdoor luminaire, cUL wet label	1T8- (1) T8 Lamp 1BX40- (1) 40w Biax ¹ 1BX50- (1) 50w Biax ¹ 1BX55- (1) 55w Biax ¹	Continuous Runs xx'- Specify nominal overall row length in 1' increments					
PN- Peak Linear natatorium luminaire, cUL wet label							

¹Cross Section
²347 volt and UNV not available with battery packs.
³Some Peak Linear configurations will not accommodate all electrical options. Consult factory.
⁴Louver is not available with biax lamp.

AIMING

Fixture achieves optimal beam angle (a) when "aiming notch" (b) aligns with horizontal or vertical axis. Luminaire head rotates and locks for easy field adjustability.

To light the wall

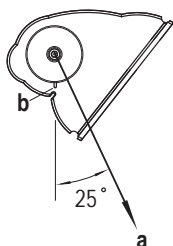

To light the ceiling

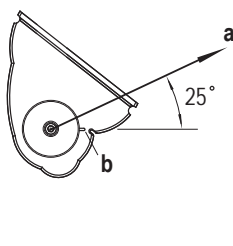

MOUNTING DIMENSION

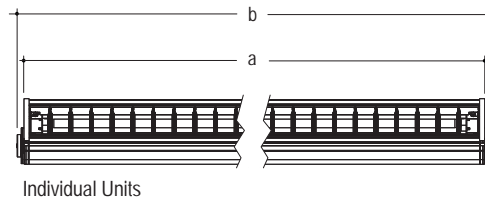

	Individual Units			
	3'	4'	6'	8'
a. Mount Spacing ¹	36-15/32"	48-15/32"	72-15/32"	96-15/32"
b. Overall Length	37-3/4"	49-3/4"	73-3/4"	97-3/4"

¹Measured to center of mounting bracket hole.

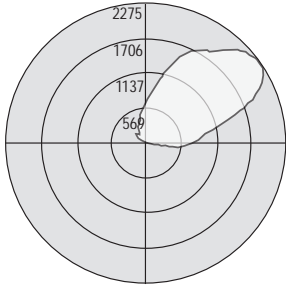

Test # 202266
Lamp: (1) 54 Watt T5HO
Total Luminaire Efficiency: 90.90%

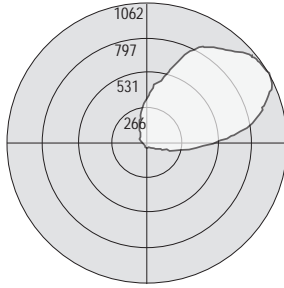

Test # 202267
Lamp: (1) 32 Watt T8
Total Luminaire Efficiency: 72.90%

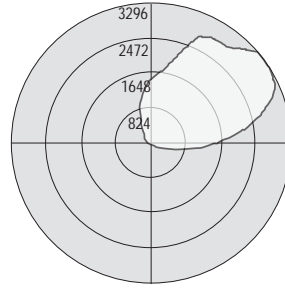

Test # 202268
Lamp: (2) 54 Watt T5HO
Total Luminaire Efficiency: 83.10%

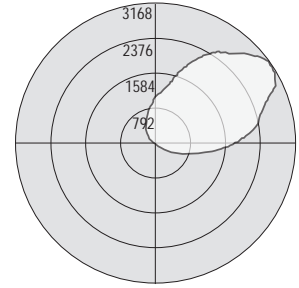

Test # 202269
Lamp: (1) 55 Watt Biax
Total Luminaire Efficiency: 71.80%

FEATURES AND OPTIONS

• VISOR

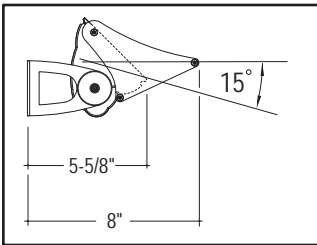

Application: Provides 15 degrees of shielding with no interference to peak beam angle. Recommended when glare from the lens or reflector must be shielded.

Construction: Solid Visors are extruded aluminum with stainless steel hardware. Visor mounts to fixture ends with 2 screws. Visors are factory installed but can be field installed. Visors are painted to match fixture housing unless otherwise specified.

Ordering Information: Indicate a "V" in the Options section of the part number. (Sample Catalog #: P-1T5HO-4-FL-120-1C-W-V)

• INTERNAL PARABOLIC LOUVER

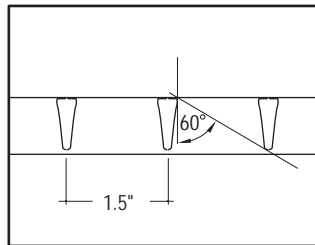

Application: Internal Parabolic louver controls glare and reduces light output by 20%. Recommended when lengthwise shielding of lamp is required.

Construction: Parabolic Louvers are straight semi-specular aluminum blades. Bottom opening is 2.58", blade height is .75" and spaced 1.5" on center. Louvers are field installed and feature a snap in attachment allowing for easy lamp replacement.

Ordering Information: Indicate an "L" in the Options section of the part number. (Sample Catalog #: P-1T5HO-4-FL-120-1C-W-L)

Restriction: Internal Louver is not available with biax lamp.

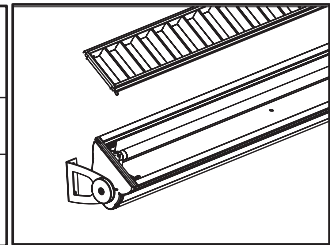

• OUTDOOR AND NATATORIUM ENVIRONMENTS

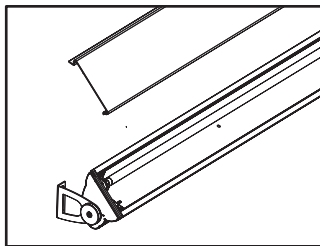
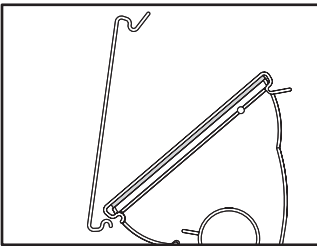

Application: Snap-on acrylic lens and gasketing prevents moisture and particle ingress for exterior and/or natatorium environments.

Construction: One-piece gasketed UV stabilized acrylic lens. Snap over acrylic lens is removable allowing for easy lamp replacement. Standard powder-coat white painted finish unless otherwise specified.

Ordering Information: Indicate either a "W" (Wet Location) or "N" (Natatorium) in the Product section of the part number. (Sample Catalog #: PW-1T5HO-4-FL-120-1C-W)

Individual Length	Nominal Row Length																																									
	3	4	6	7	8	9	10	11	12	13	14	15	16	17	18	19	20	21	22	23	24	25	26	27	28	29	30	31	32	33	34	35	36	37	38	39	40	41	42			
3	1			1		3	2	1		1	2	1		1		1		3		1		1		1		1		1		1		1		1		1		1		1		1
4		1		1			1	2		1		1							2			1		1	1		1			1		1		1	1	1		1			1	
6			1						2	1					1	3		2	2	1	2		1	1			1	1			1	1			1	1		1	1		1	1
8					1							1	1	2	1		2	1		2		3	2	2	3	3	2	3	3	4	3	3	4	4	4	3	4	4	5	4	4	