

EDGE EV4D
4" Recessed Linear

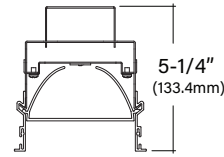

Key Features

- Extruded aluminum trim with formed cold rolled 18 gauge steel back box housing
- Highly reflective white painted steel reflector
- 5-year limited warranty covers LED, driver and fixture
- ETL Listed conforming to UL1598 in US and CSA 250 in Canada
- Approved for dry/damp location unless otherwise noted
- Maximum fixture weight is 15lbs per 4ft fixture
- Room-Side Maintenance for LED system
- Buy American Act compliant
- Indigo-Clean available, see Indigo-Clean specification sheets for details



QUICKSHIP



Example Part #: EV4D-HE-830HO-26'-G1-U-OL2-1-0-W

EV4D - SHIELDING - SOURCE - LENGTH OR PATTERN - MOUNTING - VOLTAGE - DRIVER - CIRCUITING - BATTERY & EMERGENCY - FINISH - FIXTURE OPTIONS - CONTROLS

SHIELDING	SOURCE <i>QS</i> ¹	LENGTH OR PATTERN ²	MOUNTING ^{3,5}
A - Satine Lens <i>QS</i> HE - High Efficiency Lens <i>QS</i> HED - Descent Lens BW - Batwing <i>QS</i> WHE - Asymmetric <i>QS</i> AL - Drop Lens H - Arched Regress Lens R - Regress Lens <i>Shielding pg. 2</i>	_27_ - 2700K _30_ - 3000K _35_ - 3500K (<i>available as BIOS</i>) _40_ - 4000K (<i>available as BIOS</i>) CL - Custom Lumens CW - Custom Watts MOD - Mod options available <i>Lumen Output pg. 2-3</i>	_ - Individual Fixture <i>QS</i> _ - Continuous Row <i>QS</i> L_x - L Shape <i>QS</i> R_x - Rectangle <i>QS</i> S - Square <i>QS</i> U_x - U Shape <i>QS</i> T_x - T Shape X_x_x - X Shape WC_x - Wall to Ceiling <i>QS</i> MOD - Mod options available <i>Length and Pattern pg. 3-4</i>	G1 - 1" (15/16") T Bar <i>QS</i> G9 - 9/16" T Bar <i>QS</i> GB - 9/16" Bevel T Bar GS - Screw Slot T Bar <i>QS</i> FL - 1/2" Flange <i>QS</i> NF - Non Flange <i>QS</i> SF - Spackle Flange <i>QS</i> MOD - Mod options available <i>Mounting pg. 5</i>
VOLTAGE	DRIVER	CIRCUITING	BATTERY & EMERGENCY ⁴
U - Universal <i>QS</i> <i>(120 thru 277V)</i> 1 - 120V <i>QS</i> 2 - 277V <i>QS</i> 3 - 347V <i>Voltage pg. 5</i>	FSD - Factory Select Driver (1%, 0-10v) <i>QS</i> PL2 - Advance Xitanium (1%, 0-10v) <i>QS</i> OL2 - eldoLED Optotronic (1%, 0-10v) <i>QS</i> OL4 - eldoLED Optotronic 347V (1%, 0-10v) EE1 - eldoLED ECOdrive (1%, 0-10v) ES1 - eldoLED SOLOdrive (0.1%, 0-10v) LH1 - Lutron Hi-lume (1%, EcoSystem) PR1 - Advance Xitanium SR MOD - Mod options available <i>Driver pg. 6</i>	1 - Single Circuit <i>QS</i> M - Multi Circuit E - Emergency <i>QS</i> <i>(entire fixture)</i> N - Night Light <i>QS</i> <i>(entire fixture)</i> <i>Circuiting pg. 6</i>	0 - None <i>QS</i> _FSB - Factory Select Battery _FSG - Factory Select ALCR _G1 - Iota ETS DR _GB - Bodine GTD _IC - Iota 10W (CEC Listed) <i>QS</i> _P - Bodine 10W _E - Emergency Circuit Section _N - Night Light Circuit Section _L - Life Safety Circuit Section <i>Battery and Emergency pg. 6-7</i>
FINISH	FIXTURE OPTIONS ⁵	CONTROLS ⁶	
W - White <i>QS</i> S - Metallic Silver BL - Textured Black BR - Bronze GR - Graphite CC - Custom Color <i>Finish pg. 7</i>	QS - Quick Ship <i>QS</i> CP - Chicago Plenum <i>QS</i> FIL - Field Cut Illuminated Extension RC - Rotating Crossbar GLR - Internal Fast Blow Fuse <i>QS</i> DSP - Customer Supplied Battery/Driver/Sensor MOD - Mod options available FW6 - 6' Flex Whip <i>Fixture Options pg. 7</i>	DLMFC - Wattstopper DLM (<i>wired</i>) DLMFS - Wattstopper LLLC (<i>wireless</i>) EASYS - Philips EasySense (<i>wireless</i>) SNSLM - Encelium Sensilum (<i>wireless</i>) WVLX - Eaton Wavelinx (<i>wireless</i>) VDO - Lutron Vive Sensor (<i>wireless</i>) VRF - Lutron Vive Connected (<i>wireless</i>) ENL - Enlighted (<i>wireless</i>) MOD - Mod options available <i>Controls pg. 8</i>	

1. When specifying SOURCE the first _ is for specifying either 8 - 80CRI or 9 - 90CRI. The ending __ are for specifying output, example HO - High Output. If specifying QS output is 80 CRI, all color temperatures, all lumen packages. Does not include Tunable White. See output charts for more information. 2. Individual fixtures come in 2', 3', 4', 5', 6', 7' & 8' lengths. Continuous row come in 1/8" increments. For Patterns specify pattern shape and overall dimensions. Example: L6x4: L pattern that is 6'x4'. 3. Specify mounting for individual or continuous length: G1, G9, GS, FL, NF & SF for continuous rows, G1G, G9G, GSG, FLF, NFN & SFS for individual lengths. 4. Enter quantity for Battery and Emergency, Example 2P. 5. QS must be used in fixture options section of part number to qualify. LMRA option only available with 120v. Rotating Crossbar (RC) option only available with FL and NF mounting. 6. Controls can only be used with Single Circuit (1) or Emergency Circuit (E). See Controls chart on page 5 for driver options and more information.

Specifications and dimensions subject to change without notice. Specification sheets that appear on pinnacle-ltg.com are the most recent version and supersede all other previously printed or electronic versions.



Shielding

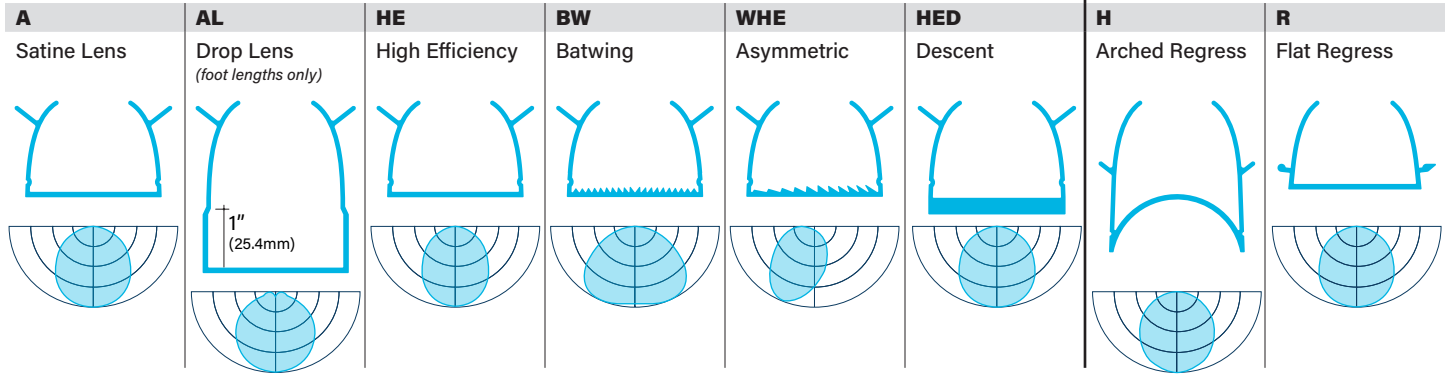

Source: White LED¹

- Specify either 80 or 90 CRI
- Longer lead-time may apply for 90 CRI. Consult factory
- 90 CRI = R9≥50
- LPW and watts/ft based off 47" fixture size.

Custom Output - Lumens OR Wattage

CL _____	Specify CRI, CCT and desired lumens (i.e. CL835500)	Specify lumens between standard offering listed below. Lumens are specified per color temp
CW _____	Specify CRI, CCT and desired wattage (i.e. CW9407)	Specify watts between standard offering listed below

80 CRI

	Color	Lumens per foot	Shielding ¹															
			A Satine		AL Drop		HE High Efficiency		BW Batwing		WHE Asymmetric		HED Descent		H Arched Regress		R Regress	
			LPW	Watts/ft	LPW	Watts/ft	LPW	Watts/ft	LPW	Watts/ft	LPW	Watts/ft	LPW	Watts/ft	LPW	Watts/ft	LPW	Watts/ft
830	3000K	500	114	4.4	103	4.9	126	4.0	122	4.1	123	4.1	113	4.4	97	5.2	103	4.9
830HO	3000K	750	114	6.6	105	7.2	130	5.8	127	5.9	127	5.9	113	6.7	98	7.6	103	7.3
830VHO	3000K	1000	117	8.5	106	9.4	131	7.6	130	7.7	130	7.7	116	8.6	98	10.2	104	9.6
835	3500K	500	118	4.3	106	4.7	130	3.9	126	4.0	127	4.0	117	4.3	100	5.0	104	4.8
835HO	3500K	750	117	6.4	108	6.9	134	5.6	131	5.7	131	5.7	116	6.4	100	7.5	106	7.1
835VHO	3500K	1000	120	8.3	108	9.2	136	7.4	132	7.6	132	7.6	119	8.4	101	9.9	107	9.4
840	4000K	500	118	4.3	106	4.7	130	3.9	126	4.0	127	4.0	117	4.3	100	5.0	104	4.8
840HO	4000K	750	117	6.4	108	6.9	134	5.6	131	5.7	131	5.7	116	6.4	100	7.5	106	7.1
840VHO	4000K	1000	120	8.3	108	9.2	136	7.4	132	7.6	132	7.6	119	8.4	101	9.9	107	9.4

90 CRI

927	2700K	500	94	5.3	84	5.9	106	4.7	103	4.9	103	4.8	94	5.3	78	6.4	83	6.0
927HO	2700K	750	96	7.8	86	8.7	108	6.9	105	7.1	105	7.1	95	7.9	80	9.4	85	8.8
927VHO	2700K	1000	95	10.5	85	11.8	108	9.2	107	9.4	107	9.4	95	10.6	N/A	N/A	N/A	N/A
930	3000K	500	103	4.9	93	5.4	115	4.3	112	4.4	113	4.4	102	4.9	85	5.9	91	5.5
930HO	3000K	750	103	7.3	94	8.0	115	6.5	112	6.7	112	6.7	102	7.3	87	8.6	92	8.1
930VHO	3000K	1000	104	9.6	94	10.7	118	8.5	115	8.7	116	8.7	104	9.7	85	11.7	92	10.9
935	3500K	500	103	4.9	92	5.4	115	4.3	112	4.5	112	4.5	102	4.9	85	5.9	90	5.5
935HO	3500K	750	102	7.3	94	8.0	115	6.5	111	6.7	112	6.7	102	7.4	87	8.6	92	8.1
935VHO	3500K	1000	104	9.6	93	10.7	118	8.5	115	8.7	115	8.7	103	9.7	85	11.8	92	10.9
940	4000K	500	103	4.9	92	5.4	115	4.3	112	4.5	112	4.5	102	4.9	85	5.9	90	5.5
940HO	4000K	750	102	7.3	94	8.0	115	6.5	111	6.7	112	6.7	102	7.4	87	8.6	92	8.1
940VHO	4000K	1000	104	9.6	93	10.7	118	8.5	115	8.7	115	8.7	103	9.7	85	11.8	92	10.9

¹LPW and watts/ft based off 47" fixture size.

Specifications and dimensions subject to change without notice. Specification sheets that appear on pinnacle-ltg.com are the most recent version and supersede all other previously printed or electronic versions.



Source: BIOS¹

- CRI >84, R9 >90
- Spectrum focused lighting for circadian stimulus
- High EML or M/P ratio: .8 for 3500K, .9 for 4000K
- COI: ≤3.3
- Available for use with most Driver or Control options

Custom Output - Lumens OR Wattage

CLB _____	Specify CRI, CCT and desired lumens (i.e. CL835500)	Specify lumens between standard offering listed below. Lumens are specified per color temp
CWB _____	Specify CRI, CCT and desired wattage (i.e. CW9407)	Specify watts between standard offering listed below

BIOS

	Color	Lumens <i>per foot</i>	Shielding ¹					
			A Satine		HE High Efficiency		BW Batwing	
			LPW	Watts/ft	LPW	Watts/ft	LPW	Watts/ft
B35	3500K	500	70.1	7.1	81	6.2	79	6.3
B35HO	3500K	750	69.3	10.8	82	9.2	79	9.5
B35VHO	3500K	1000	N/A		79	12.7	N/A	
B40	4000K	500	72.0	6.9	83	6.0	81	6.2
B40HO	4000K	750	71.3	10.5	84	8.9	82	9.2
B40VHO	4000K	1000	N/A		81	12.3	N/A	

Direct Source: MOD Options

- Specify **MOD** in the part number for any of the below options
- All RGB_Source Options will require specific driver and control
- Consult factory for **MOD** specification details, pricing, and lead-time information

	Required Driver	Required Control
MOD Color Changing RGB LED	EC1/EC4	DMX
Color Changing RGB-W LED	EC1/EC4	DMX
2 Channel Tunable White		

¹LPW and watts/ft based off 47" fixture size.

Length

- All individual units cannot be joined, end trims are factory installed and cannot be removed
- Refer to Pattern section for specification and ordering options
- Continuous Rows are made up of even and odd length fixtures; designed to fall on-grid
- BIOS and Blanco3 are only available in foot lengths

2	3	4	5	6	7	8	—
Indiv. Fixture	Indiv. Fixture	Indiv. Fixture	Indiv. Fixture	Indiv. Fixture	Indiv. Fixture	Indiv. Fixture	Cont. Run
23" (584.2mm)	35" (889mm)	47" (1193.8mm)	59" (1498.6mm)	71" (1803.4mm)	83" (2108.2mm)	95" (2413mm)	Specify nominal overall row length to the 1/8" not available with H or R shielding options
Specify to the 1/8" >>>							

Specifications and dimensions subject to change without notice. Specification sheets that appear on pinnacle-ltg.com are the most recent version and supersede all other previously printed or electronic versions.



Pattern

- Specify pattern shape and overall dimensions (includes corner dimensions)
- 90 degree horizontal corners are 12"x12" (overall, outside dimension)
- Angles and shapes not shown require Mod Pattern; consult factory
- Only available with A or HE Lenses
- Not all drivers available with all patterns; consult factory

S	R_x	U_x_x	L_x	T_x	X_x	WC_x	M
Square Provide A dimension Example: S4' Nominal Length- 4'x4' Minimum Length- 3'11"x3'11"	Rectangle Provide AxB dimensions Example: R4'x4' Nominal Length- 4'x4' Minimum Length- 3'11"x3'11"	U-Shape Provide AxBxC dimensions Example: U3'x4'x3' Nominal Length- 3'x4'x3' Minimum Length- 2'11"x3'11"x2'11"	L-Shape Provide AxB dimensions Example: L3'x3' Nominal Length- 3'x3' Minimum Length- 2'11"x2'11"	T-Shape Provide AxB dimensions Example: T3'x5' Nominal Length- 3'x5' Minimum Length- 2'11"x4'10"	X-Shape Provide AxB dimensions Example: X5'x5' Nominal Length- 5'x5' Minimum Length- 4'10"x4'10"	Wall to Ceiling Provide WxC dimensions Example: WC2'x2' Nominal Length- 2'x2' Minimum Length- 1'11"x1'11"	ModLayout For patterns or lengths not shown or standard

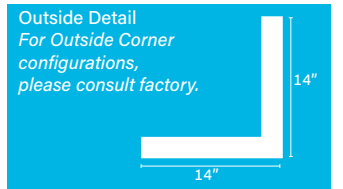
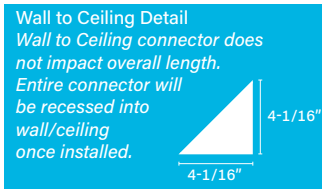
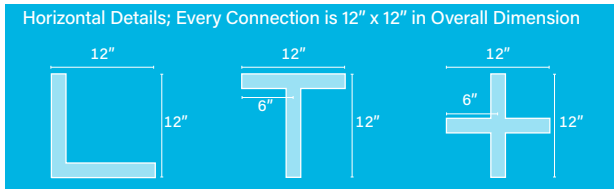
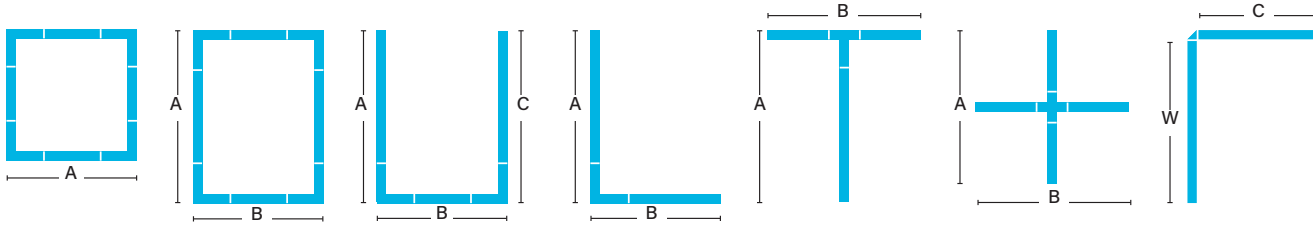

Length or Pattern: MOD Options

- Specify **MOD** in the part number for any of the below options
- Consult factory for **MOD** specification details, pricing, and lead-time information

MOD	Specify MOD for patterns, lengths or angles not shown above
	45- 180 degree angles
	Single-piece welded housings up to 4' x 4'

Specifications and dimensions subject to change without notice. Specification sheets that appear on pinnacle-ltg.com are the most recent version and supersede all other previously printed or electronic versions.



Mounting

- Individual units cannot be joined, end trims are factory installed and cannot be removed
- Designed to install into acoustical grid and inaccessible ceilings
- Grid retention brackets integral to housing and require mechanical attachment
- Each housing contains 4 grid retention brackets
- Tie off fixture to structure with retention wires
- Approved for dry/damp location unless otherwise noted

G1	G9	GB	GS	FL	NF	SF
<p>1" (15/16") T-Bar Flange to Flange: 4-13/16" (122.2mm)</p> <p>Standard Tile</p> <p>Tegular Tile</p>	<p>9/16" T-Bar For tegular tile installations, fixture position will not be flush to the bottom of the tile Flange to Flange: 4-13/16" (122.2mm)</p> <p>Standard Tile</p> <p>Tegular Tile</p>	<p>9/16" T-Bar Rail has bevel edge details. For tegular tile installations, fixture position will be flush to the bottom of the tile Flange to Flange: 4-13/16" (122.2mm)</p> <p>Tegular Tile</p>	<p>Screw Slot & 9/16" T-Bar For 9/16" installations with tegular tile, fixture position will be flush to the bottom of the tile Flange to Flange: 4-13/16" (122.2mm)</p> <p>Tegular Tile</p>	<p>Exposed Standard 1/2" Flange Detail Flange to Flange: 5-1/8" (130.2mm)</p>	<p>Metal Pan or Millwork Flange to Flange: 4-7/16" (112.7mm)</p>	<p>Drywall, Flangeless Detail Flange to Flange: 6" (152.4mm)</p>
<p>RC Optional Rotating Crossbar</p>						

Mounting: MOD Options

- Specify **MOD** in the part number for any of the below options
- Consult factory for **MOD** specification details, pricing, and lead-time information

MOD	Recessed to Suspended
	Alternative Ceiling Solutions
	Combination Rails

Voltage

- Some EV4D configurations will not accommodate all voltage options; consult with factory

U	Universal
1	120 volt
2	277 volt
3	347 volt



Driver

- Standard Driver Option = FSD
- Driver Lifetime: 50,000 hours at 25°C ambient operating conditions
- For more driver options see Pinnacle Resource Guide
- Some EV4D configurations will not accommodate all driver options; consult with factory

0-10V Drivers

FSD	Factory Select Driver 1%, 0-10v
PL2	Signify Advance Xitanium 1%, 0-10v
PL4	Advance Xitanium 347v 1%, 0-10v, requires 347v
OL2	eldoLED Optotronic, 1%, 0-10v
OL4	eldoLED Optotronic 347v, 1% 0-10v, requires 347v option
EE1	eldoLED ECOdrive 1%, 0-10v Logarithmic
EE2	eldoLED ECOdrive 1%, 0-10v Linear
ES1	eldoLED SOLOdrive 0-10v, 0.1% Logarithmic
ES2	eldoLED SOLOdrive 0-10v, 0% Linear
OL5	eldoLED Optotronic 1%, 0-10v, AUX
PL5	Advance Xitanium 1%, 0-10v, AUX

DALI Drivers

EE3	eldoLED ECOdrive .1%, DALI (logarithmic)
ES3	eldoLED SOLOdrive .1%, DALI (logarithmic)
OD1	eldoLED Optotronic 1%, DEXAL
OD2	eldoLED Optotronic 1%, DALI 2 Channel

Lutron Drivers

LH1	Lutron Hi-lume Soft-on, Fade-to-black 1%, EcoSystem, LDE1
LH4	Lutron Hi-Lume 1%, 2-wire, Lutron-LTEA2W, 120v only

Alternate Drivers

PS1	Signify Advance Xitanium Step Dimming 50%/100%
PR1	Philips Advance Xitanium SR, requires EASYS, VDO or VRF
OD1	eldoLED Optotronic 1%, DEXAL
EH1	ELV 120v only, 0-10v universal
EC2	Constant Voltage LED driver, 120v or 277v required

Driver: MOD Options

- Specify **MOD** in the part number for any of the below options
- Consult factory for **MOD** specification details, pricing, and lead-time information

MOD	Power Over Ethernet
------------	---------------------

How to Specify Circuiting, Battery and Emergency

- Select fixture circuiting from options below
 - Some EV4D configurations will not accommodate all circuiting options, consult with factory

Circuiting

1	Single Circuit
M	Multi Circuit <i>(Not available with controls)</i>
E	Emergency Circuit only <i>(uses nIO EZ PH ER with NLIGHT)</i>
N	Night Light Circuit only

- Battery and emergency section options are available in addition to fixture circuit
 - Select battery and emergency section options below; factory shop drawing required
 - Some EV4D configurations will not accommodate all circuiting options, consult with factory

Battery and/or Emergency *If Required*

0	No battery or specific emergency section required
----------	---



Battery

- Select battery section type if required, indicate total QTY. *Example 2P*
- 90 minute battery runtime; test button location dependant on configuration, consult factory
- No battery option available for 2' & 3' lengths
- Entire fixture is on battery for lengths up to 5'
- Half of fixture is on battery for 6' or 8' housing lengths
- For more battery options available, see Pinnacle Resource Guide

0	No Battery
_FSB	Factory Select Battery (10w option)
_FSBST	Factory Select Battery (10w, Self Testing)
_IC	Iota 10w Integral
_ILL	Iota 10w Integral Lithium, Self Testing
_IRH	Iota 20w Remote
_P	Bodine 10w Integral
_PRH	Bodine 20w Remote
_PLL	Bodine 10w Integral Lithium, Self Testing

For Approximate Battery Lumen Output

- Multiply battery wattage X fixture LPW shown on Lumen Table
- 92.3 (LPW) x 10 (watts) = 923 battery lumen output

Emergency

- Select emergency section type if required, indicate total QTY. *Example 1E*
- Combine battery and emergency section ordering codes if both options are selected

_FSG	Factory Select Automatic Load Control Relay (ALCR), UNV
_GI	Emergency Transfer Switch (ETS) DR Emergency Control Device, UNV
_GB	Bodine GTD, Generator Transfer Device, 120v or 277v
_E	Emergency circuit section <i>(NIGHT ONLY full housing not sections)</i>
_N	Night Light circuit section
_L	Life Safety circuit section NO THROUGH WIRE

Battery OR Emergency Ordering Examples

- Single circuit, 10w Integral Battery Ordering Code: 1-1P
- Emergency only, 10w Integral Battery Ordering Code: E-1P
- Single circuit, GTD required Ordering Code: 1-1G

Combination Section Ordering Examples

- Single circuit, (1) 10w battery, (1) emergency section Ordering Code: 1-1P1E
- Multi circuit, (2) 10w battery, (2) emergency sections Ordering Code: M-2P2E
- Single circuit, (1) night light section Ordering Code: 1-1N

Finish

- Standard powder-coat textured white, metallic silver, textured black, graphite or bronze painted finish; consult factory for chip of standard paint finishes
- Selecting a fixture finish other than white may impact lumen output; consult factory for more information

W	White
S	Metallic Silver
BL	Textured Black
GR	Graphite
BR	Bronze
CC	Custom Color

Fixture Options

- FIL has 2" min - 12" max length
- FIL Option angle range is 40° to 90°
- FIL Option is not IC rated
- Rotating Crossbar (RC) option only available with FL and NF mounting.

QS	Quick Ship
CP	Chicago Plenum
FIL	Field Cut Illuminated Extension
RC	Rotating Crossbar
DSP	Customer Supplied Battery/Driver/Sensor
GLR	Internal Fast Blow Fuse
FW6	6' Flex Whip

Quick Ship

Shielding	CRI, CCT & Output	Mounting	Voltage	Driver	Circuiting	Battery	Finish
-----------	-------------------	----------	---------	--------	------------	---------	--------

10-Day								
A	80 CRI, all color temperatures, all lumen packages <i>See pg 2</i>	G1(G)	1" T-Bar	U Universal (120-277) 1 120V 2 277V	FSD Factory Select Driver <i>(1%, 0-10v)</i>	1 Single Circuit E Emergency N Night Light	0 None _IC Iota 10w Integral	W White
HE		G9(G)	9/16" T-Bar		PL2 Advance Xitanium 1%, 0-10v			
BW		GS(G)	Screw Slot		OL2 Osram 0-10v, 1%			
WHE		FL(F)	1/2" Flange					
		NF(N)	Flangeless					
		SF(S)	Spackle Flange					

All lengths and continuous rows up to 1,000 ft OR 150 individual fixtures. Consult factory for larger projects.

Specifications and dimensions subject to change without notice. Specification sheets that appear on pinnacle-ltg.com are the most recent version and supersede all other previously printed or electronic versions.

Designed in Denver, CO - USA | pinnacle-ltg.com | O: 303-322-5570 F: 303-322-5568

EV4D_LED_SPEC_DEC2023



Fixture Options: MOD Options

- Specify **MOD** in the part number for any of the below options
- Consult factory for **MOD** specification details, pricing, and lead-time information

MOD Remote Driver

Controls

- Pinnacle Lighting offers easy to specify network control solutions that connect to an intelligent centralized system to maximize lighting energy efficiencies or integral sensors for individual fixture control
- Pinnacle Lighting fixtures ship technology ready; commissioning by others
- Controls can only be used with Single Circuit (1) or Emergency Circuit (E)
- Contact factory for any non-standard configurations for layout, placement, or EM options
- One drop per sensor typical, consult factory for more information

	Solution	Components	Network/Sensor	Connection	Required Drivers	Limitations
DLMFC	Legrand Wattstopper DLM	LMFC-011	Digital Lighting Management (DLM)	Wired, two RJ45 ports	OL2, OL4	Not available with Battery
DLMFS	Legrand Wattstopper LLLC	LMFS-601-W / LMFI-111	Wireless DLM Fixture Sensor	Wireless	OD1, PR1, 0-10v	0-10v requires interface
EASYS	Philips EasySense	SNS-210	Daylight/PIR Occupancy	Wireless to switches	PR1	Not available with 347 volt
SNSLM	Encelium Sensilum	EN-CLM-PIR-DD-ZB	Encelium, Daylight/PIR Occupancy	Wireless	OD1, OL5	Not available with 347 volt
WLWX	Eaton Wavelinx	SWPD1, NSP3IVMVDC1	WaveLinx WCL, Daylight	Wireless	Any 0-10v	Not available with 347 volt
VDO	Lutron Vive Sensor	DFCSJ-OEM-OCC	Vive, Daylight/PIR Occupancy	Wireless	OD1, PR1	Not available with 347 volt
VRF	Lutron Vive Connected	DFCSJ-OEM-RF	Vive	Wireless	OD1, PR1	Not available with 347 volt
ENLI	Enlighted	SU-5E-IOT, CU-4E	Enlighted, Daylight/PIR Occupancy	Wireless	Any 0-10v	Not available with 347 volt
ENLC	Enlighted	SU-5E-CL, CU-4E	Enlighted, Daylight/PIR Occupancy	Wireless	Any 0-10v	Not available with 347 volt

Controls: MOD Options

- Specify **MOD** in the part number for any of the below options
- Control** Options may require specific driver. Refer to the chart below
- Consult factory for **MOD** specification details, pricing, and lead-time information

MOD Acuity nLight Air Wireless Connected

Required Driver
EE6, ES6

Photometrics

Satine Lens

Test # ITL91432
Catalog # EV2D-A-840VHO-4
Lumens 4020 lm
Watts 34.7 w
Efficacy 116 LPW

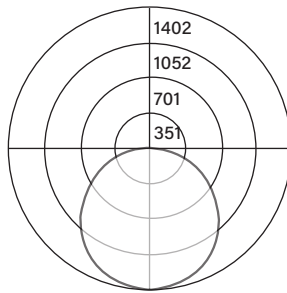

Candela Distribution

Vert Angle	Horizontal Angle				
	0	22.5	45	67.5	90
0	1400	1400	1400	1400	1400
5	1393	1395	1397	1398	1399
10	1379	1382	1382	1379	1381
15	1348	1344	1350	1350	1348
20	1306	1298	1306	1307	1304
25	1253	1245	1253	1254	1247
30	1191	1178	1185	1184	1183
35	1112	1104	1112	1108	1105
40	1030	1023	1029	1027	1024
45	940	932	935	932	930
50	839	834	836	833	830
55	734	730	730	729	727
60	624	618	619	618	615
65	507	504	503	501	503
70	388	386	387	388	387
75	269	268	271	273	274
80	156	160	164	166	168
85	65	66	70	73	73
90	0	0	0	0	0

Luminance Data (cd/sq.m)

Angle In Degrees	Average 0-Deg	Average 45-Deg	Average 90-Deg
45	10950	10892	10833
55	10541	10483	10440
65	9882	9804	9804
75	8561	8625	8720
85	6143	6616	6899

For all available IES files, please visit our website at pinnacle-ltg.com. Photometry testing in accordance to IESNA-LM-79-08 at an NVLAP accredited testing laboratory. Testing conducted at 25°C ambient conditions.



Applications & Certificates

Construction: Formed cold-rolled 18 gauge steel housing. Highly reflective die-formed white painted steel reflector.

Shielding: Diffuse snap-in acrylic lens, removable for maintenance.

Mounting: EDGE is designed to install into acoustical grid and inaccessible ceilings. Specify GXG, FLF, SFS, NFN for individual, unjoinable units (individual units will fall on-grid). Specify GX, FL, SF, NF for continuous runs (runs designed to fall on-grid). Consult factory for detailed installation instructions. Maximum fixture weight is 15lbs per 4' fixture.

White LED: 25°C test environment. Lumen output/wattage has a margin of +/- 5%; 2' or 3' lengths may have a greater wattage deviation. Luminaire configurations tested in accordance with IES LM-79. Diodes tested in accordance with IES LM-80. Lifetime calculated using IES TM-21. Minimum lifetime greater than 60,000 hours. Lifetime Projection L70 = 146,500 hours and L90 = 45,000 hours. MacAdam 3-Step Ellipses. Not all products are Lighting Facts listed. For all available IES files, please visit our website at pinnacle-ltg.com. Three lumen packages available. Standard, High (HO) and Very High (VHO). Custom outputs are available. Specify custom lumens or watts between standard offering listed on CRI, CCT & Output page. 80 CRI is available for 3000K, 3500K, and 4000K. 90 CRI is available for 2700K, 3000K, 3500K, and 4000K. 90 CRI = R9≥50.

BIOS LED: Spectrum focused lighting for circadian stimulus. EML or M/P ratio: .8 for 3500K, .9 for 4000K. COI >3.0. Not all lumen packages available. Three lumen packages available. Standard, High (HO) and Very High (VHO). Custom outputs are available. Specify custom lumens or watts between standard offering listed on CRI, CCT & Output page.

Tunable White LED: Blanco 3; 3 Channel tunable white for precise black body curve CCT. Self-commissioning with Wattstopper DLM integrated controls. Custom lumen output and color temperature configurations require use of controls.

Voltage: Universal (U), 120 volt (1), 277 volt (2) and 347 volt (3) options available. Must specify OL4 in Driver section when 347 volt (3) is selected. Some EDGE configurations will not accommodate all voltage options; consult with factory.

Driver: Standard Driver Option is Advance Xitanium 0-10V, 1% = PL2. Electronic driver, Power factor is >0.9 with a THD <20%. Driver Lifetime: 50,000 hours at 25°C ambient operating conditions. Ambient operating range: -20°F/-30°C to 81.3°F/27.4°C. For more driver options, see Pinnacle Resource Guide. Some EDGE configurations will not accommodate all driver options.

Circuiting: Select from single circuit (1), Multi circuit - For multiple circuiting and zone control, requires factory shop drawing (M), Emergency circuit (E), Life Safety (L) or Night Light circuit (N). For emergency circuiting situations that require no through wire or cir-

cuit separation, Life Safety Circuit should be selected. This will provide a separate power feed and only the Life Safety Circuit in that section. Some EDGE configurations will not accommodate all circuiting options; consult with factory.

Battery & Emergency: Select battery or emergency options if required. If battery or emergency option is not required, enter 0. Battery duration is 90 minutes as standard. Test button location dependant on configuration, consult factory. For more Battery options, see Pinnacle Resource Guide.

Finish: Standard powder-coat textured white, metallic silver, textured black, graphite or bronze painted finish; consult factory for chip of standard paint finishes or for additional custom color and finish options.

Controls: DLM utilizes wired network connections for digital control through switching and dimming. nLight Air rES7 sensor provides wireless control, daylight harvesting and occupancy detection with PIR using eldoLED LED drivers. nLight Air rES7 sensor provides wireless control, daylight harvesting and occupancy detection with PDT using eldoLED LED drivers. nLight Air rIO module provides wireless control using eldoLED LED drivers. EasySense sensor provides daylight harvesting and PIR occupancy detection using the SR LED driver; the Philips app provides advanced configurations. ENCELIUM SensiLUM sensor provides wireless control, daylight harvesting and PIR occupancy; driver data is available when using the DEXAL driver. ENCELIUM SensiLUM sensor provides wireless control, daylight harvesting and PIR occupancy; driver data is available when using the DEXAL driver. Wavelinx Connected Lighting sensor provides wireless control and daylight harvesting using 0-10V LED drivers. Lutron Vive sensor provides wireless control, daylight harvesting and PIR occupancy detection using DEXAL or SR LED drivers. Lutron Vive module provides wireless control using DEXAL or SR LED drivers. Enlighted Smart Sensor provides multi-functionality including daylight harvesting and PIR occupancy; for IOT platform using 0-10v LED drivers. Enlighted Smart Sensor provides multi-functionality including daylight harvesting and PIR occupancy; for Connected platform using 0-10v LED drivers.

Labels: UL and cUL 2108 or 1598 listed depending on product configuration. Standard, HO and VHO lumen packages are IC Rated, approved for dry/damp location unless otherwise noted.

Fixture Weight: Maximum fixture weight is 15lbs per 4' fixture.

Buy American Act Compliant

Warranty: EDGE LED offered with a 5-year limited warranty. Covers LED, driver and fixture.